

APPLICATION TO INSTALL PRIVATE LINE

DATE: 7-30-19

TO THE COMMISSIONERS COURT OF BROWN COUNTY,

Application is hereby made by Zephyr Water Supply Corp., to install a buried  or aerial  water  line within the right-of-way and/or across a county road in Brown County, Texas, as follows:

Precinct# 3 Location CR 321 & CR 330  
This will involve a bore  or cut , or just ROW .

The location and description of the proposed line and associated appurtenances is more fully show by the plat of such line attached to this application. The line will be constructed and maintained on the County right-of-way in accordance with governing laws. And installed at a depth of 24" to 30" below the lowest level of the bar ditch.

The applicant agrees to remove or relocate such fixtures at his own expense so as to permit the widening or changing of traffic lanes or reconstruction of the roadbed. Such removal or relocation shall be within 30 days of written notice specifying the fixtures to be moved and indicate the place on the roadway to which they shall be replaced.

Notwithstanding any other provision contained herein, it is expressly understood that tender of this notice by the undersigned does not constitute a waiver, surrender, abandonment or impairment of any property rights, franchise, easement, license, authority, permission, privilege or right now granted by law or may be granted in the future and any provision of provisions so construed shall be null and void.

The Commissioner of the above precinct will be notified of the time and date of installation at least 24 hours in advance.

This permit will become null and void if work is not completed within 90 days from date of acceptance by the Brown County Commissioners Court.

I certify that the above-proposed installation will not impair or harm the ingress and egress of adjacent landowners.

Construction of this line will begin on or after the 5 day of Aug, 2019.

BY: Zephyr Water Supply

Address P.O. Box 722

Zephyr Tex 76890

Telephone 325 739-5267

M. Ke Beal  
642-9511

August 5, 2019  
(Exhibit #5)

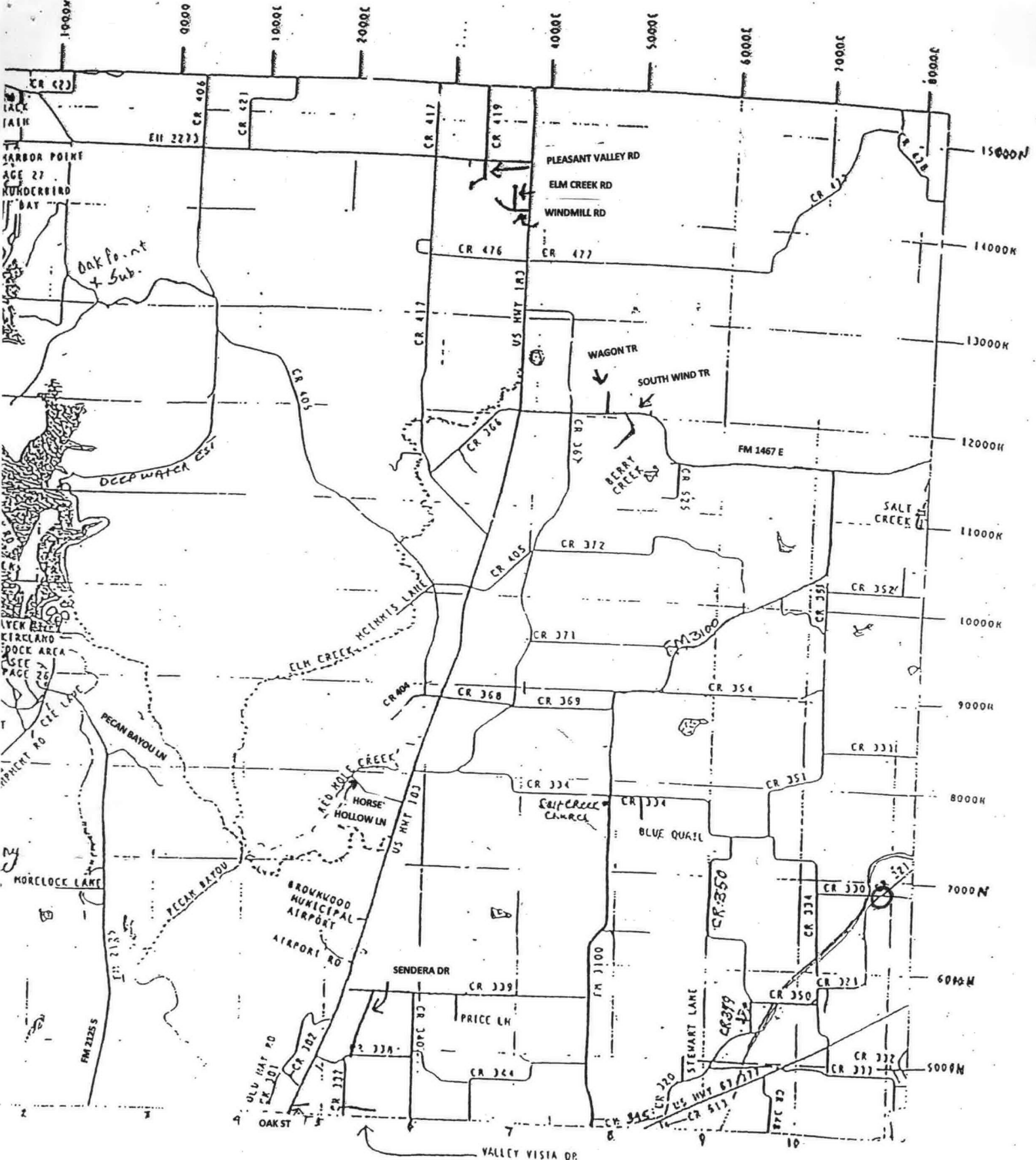

CR 423  
HARBOR POINT  
AGE 27  
HUNDREDBIRD  
BAY  
LYCK BAY  
KIRKLAND  
DOCK AREA  
AGE 26  
SEE PAGE 26  
PECAN BAYOU LN  
MORLOCK LANE  
FM 2125  
FM 2225

Oak Point  
+ Sub.

DEEP WATER EST  
ELM CREEK MCINNIS LANE  
RED HOLE CREEK  
HORSE HOLLOW LN  
BROWNWOOD MUNICIPAL AIRPORT  
AIRPORT RD  
SENDERA DR  
PRICE LN  
CR 338  
CR 339  
CR 340  
CR 341  
CR 342  
CR 343  
CR 344  
CR 345  
CR 346  
CR 347  
CR 348  
CR 349  
CR 350  
CR 351  
CR 352  
CR 353  
CR 354  
CR 355  
CR 356  
CR 357  
CR 358  
CR 359  
CR 360  
CR 361  
CR 362  
CR 363  
CR 364  
CR 365  
CR 366  
CR 367  
CR 368  
CR 369  
CR 370  
CR 371  
CR 372  
CR 373  
CR 374  
CR 375  
CR 376  
CR 377  
CR 378  
CR 379  
CR 380  
CR 381  
CR 382  
CR 383  
CR 384  
CR 385  
CR 386  
CR 387  
CR 388  
CR 389  
CR 390  
CR 391  
CR 392  
CR 393  
CR 394  
CR 395  
CR 396  
CR 397  
CR 398  
CR 399  
CR 400  
CR 401  
CR 402  
CR 403  
CR 404  
CR 405  
CR 406  
CR 407  
CR 408  
CR 409  
CR 410  
CR 411  
CR 412  
CR 413  
CR 414  
CR 415  
CR 416  
CR 417  
CR 418  
CR 419  
CR 420  
CR 421  
CR 422  
CR 423  
CR 424  
CR 425  
CR 426  
CR 427  
CR 428  
CR 429  
CR 430  
CR 431  
CR 432  
CR 433  
CR 434  
CR 435  
CR 436  
CR 437  
CR 438  
CR 439  
CR 440  
CR 441  
CR 442  
CR 443  
CR 444  
CR 445  
CR 446  
CR 447  
CR 448  
CR 449  
CR 450  
CR 451  
CR 452  
CR 453  
CR 454  
CR 455  
CR 456  
CR 457  
CR 458  
CR 459  
CR 460  
CR 461  
CR 462  
CR 463  
CR 464  
CR 465  
CR 466  
CR 467  
CR 468  
CR 469  
CR 470  
CR 471  
CR 472  
CR 473  
CR 474  
CR 475  
CR 476  
CR 477  
CR 478  
CR 479  
CR 480  
CR 481  
CR 482  
CR 483  
CR 484  
CR 485  
CR 486  
CR 487  
CR 488  
CR 489  
CR 490  
CR 491  
CR 492  
CR 493  
CR 494  
CR 495  
CR 496  
CR 497  
CR 498  
CR 499  
CR 500

PLEASANT VALLEY RD  
ELM CREEK RD  
WINDMILL RD

WAGON TR  
SOUTH WIND TR

BERRY CREEK

SALT CREEK

SALT CREEK Church

BLUE QUAIL

STEWART LANE

VALLEY VISTA DR

CR334

HWY 67-37E

CR321

CR329

CR330

CR327

Source: Esri, DigitalGlobe, GeoEye, Earthstar Geographics, CNES/Airbus DS, USDA, USGS, AeroGRID, IGN, and the GIS User Community



APPROVAL:

Zephyr Water Supply  
P.O. Box 722  
Zephyr TX 76890

---

The Commissioner's Court of Brown County offers no objections to the location on the right-of-way and/or crossing of your proposed buried line as shown by accompanying drawings and notice dated August 5, 2019, except as noted below:

It is further intended that the Commissioner's Court may require the owner to relocate This line, subject to provisions of governing laws, by giving thirty (30) days written notice.

The installation shall not damage any part of the county road and adequate provisions must be made to cause a minimum inconvenience to traffic and adjacent property owners.

Please notify Wayne Shaw, Commissioner of Precinct # 3,  
Twenty-four (24) hours prior to starting construction of the line, in order that we may have a representative present.

BROWN COUNTY COMMISSIONERS COURT  
OF BROWNWOOD, TEXAS

BY: Paula [Signature]

---

Exceptions and/or special requirements:

According to Brown County specifications.